

## NAZARETH CATHOLIC COLLEGE

Our largest project this year has been Stage 1 of the Nazareth Catholic Community at Flinders Park. The project involves the merging of three Catholic primary schools in the western region of Adelaide with Siena College, a secondary girl's school, to form a co-educational school of 1600 students from Reception to Year 12. To provide a central site for the secondary school, the Catholic Education Office purchased the northern part of the former UniSA Underdale campus, which included a gym and several large physical education teaching spaces.

The concept central to the new development is to include significant partnerships with contributing parishes, an R-12 school, and a variety of faith and community services designed to support and strengthen families in their own empowerment. The project sees families as "domestic church" and as healthy, vital places where all family members can be nurtured and loved and in turn, love and nurture.

Stage One provides educational facilities for 840 students, including 5,000 m<sup>2</sup> of refurbished buildings and 4000 m<sup>2</sup> of new two-storey buildings. There are two main new buildings, both two storeyed.

The northern wing accommodates school administration, a Year 12 Centre, and general learning areas with associated breakout spaces to provide flexible learning opportunities. The southern wing accommodates technical studies and art facilities at ground level and science facilities at the upper level. The science facilities are innovative in providing three practical spaces and seven tutorial spaces in one open space area. This allows general teaching to occur in the tutorial spaces with students moving to the practical spaces only for the time required to undertake their practical work.

The entry to the school is designed to reflect the central concept of the community: a space where education, community and worship spaces exist together. There is a small "sacred space" at the entry behind a steel sculptural screen, with access to the school reception area and a foyer/café providing "integrated services" such as counselling, career and further education advice.

The existing double gym is being retained both for school use and for community use after hours. The existing building will also accommodate the resource centre, drama centre and Technology and Food domestic and commercial teaching kitchens plus staff room and offices. There is a strong emphasis on Information and Communications Technology, with an extensive wired network complemented with wireless networking and extensive use of laptops.

The school is one of the first that is required to comply with the new section J energy efficient provisions of the Building Code of Australia.

It is planned to commence construction early next year, with the site opening for 2008. In the meantime planning has commenced for the primary school redevelopment of the existing Siena and Our Lady of the Manger sites at Crittenden Road, Findon, due to open in 2009

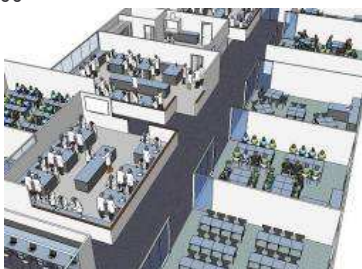

## CONCORDIA



Work was completed in March this year on the new Yangadlitya Resource Centre at Concordia College. Wedged between the rear street and the original two-storey heritage building, this new Centre allows direct access from the street to the main reception area, provides a large new resource area on the ground floor and five new learning areas and a shared computer suite upstairs. The ground floor of the west wing of the original building has also been refurbished to provide senior management offices.

The replanning of this area has allowed direct connection between public and teaching spaces, and a glazed link at the upper level between the old and new buildings articulates the connection between the two buildings.

Considerable thought was given to sustainable solutions for heating and cooling, with air to air heat exchangers allowing high levels of fresh air into the building while at the same time lowering running costs.

A lightwell into the resource centre allows overlooking from the upper walkway and natural light to penetrate into the ground floor.



## KELLY WING OPENING



In October Russell and Yelland attended the opening of the new Kelly wing at St Josephs School in Port Lincoln. The new Kelly Centre represents the final, and largest stage of a three stage masterplan at the school. The new centre incorporates six new classrooms and specialist learning assistance facilities. Along with the new Kelly centre this stage incorporated the redevelopment of the school's science facilities and extensive site works, which produced consolidated external spaces and proper access to classrooms.

## ST JOHNS OPENING

This year Russell and Yelland attended the opening of the new Manual Arts and Home Economics Centres at Saint Johns College in Whyalla. The manual arts centre incorporates new technical studies facilities and redeveloped art and electronics areas. The home economics centres involved the construction of a new commercial kitchen and redeveloping the schools existing domestic kitchen.

The opening of these centres brings the first and second stages of a three stage masterplan to completion. The school is currently constructing new hard-court playing surfaces and has future plans for the development of a new drama centre.

## GALILEE LEARNING COMMUNITY, ALDINGA



The main focus of the new Catholic primary school which will open at Aldinga in 2007 is to break down old patterns of teaching, instead allowing students to learn how to learn.

Based on the principles of life-long learning and strength in community, the Galilee Catholic Learning Community is the first stage of the Galilee Catholic Community, a joint venture between the Catholic Education Office and the local Catholic community aimed at creating a welcoming base for the whole community.

Stage One of the project has included carparking, a retention dam and swale and the first of the Learning Community spaces; including both internal and external learning areas. A large light-filled Shared Space, four smaller Learning Spaces and ancillary rooms make up the interior of this Stage One Learning Community. A range of external learning spaces surround the development, including wide verandahs, an almond orchard and a sand dune mound.

We congratulate and thank all those involved in the creation of this first stage of the Galilee Catholic Community, especially Tina Adamo the new principal, Alex Bennett from the Catholic Education Office and Paul and Brian from Tagara Builders. Their enthusiasm, drive and knowledge have been so wonderful to work with.



## RTC CONVENTION

Russell and Yelland were represented at this years national RTC (REVIT Technology Conference) in New South Wales. Stewart Caldwell gave a talk on the use of SketchUp and its integration into REVIT. REVIT is a three dimensional parametric building information modelling package which Russell and Yelland use when designing and documenting buildings. REVIT gives the opportunity to simulate the building in a three dimensional environment which allows for detailed building analysis.

SketchUp is a fast, simple but exceptionally effective three dimensional sketch design tool. R&Y use SketchUp as a design exploration tool before progressing into detailed 3-D modeling. At this year's RTC Russell & Yelland presented on the use of SketchUp and REVIT together to develop comprehensive design solutions

## OTHER PROJECTS

- Our work with the **DFC Asset Services** (previously the **SA Housing Trust**) has included a number of interesting projects including a proposal to refurbish the Box Factory community Centre and preliminary design work on an innovative medium density housing project at Port Noarlunga.
- We have documented on several store refurbishment projects for **Woolworths** using our Revit CAD software.
- Work has recently been completed on a computer lab for the **University of Adelaide**. See the article below on the use of sketch up for the design of this project.
- Redevelopment of the **University of Adelaide** Sports Hub is nearing completion in the University Union Building.
- We are presently working on a number of projects for the **Jarvis** group of companies.
- The Stage 1 Redevelopment of **St Johns Lutheran Primary School** is due for completion in January and features the conversion of the original Julia Farr Centre maintenance building into a new library and resource centre.

EMERALD ALLIANCE  
a group of like-minded B2B consultants

EMERALD ALLIANCE

No, not something from the Wizard of Oz, but a group of design professionals working towards common goals of sustainable design. Coordinated by David Oppenheim of Sustainable Built Environments in Melbourne, it includes practices in Sydney, Brisbane, Gold Coast, London and of course Adelaide. Learn more at [www.emeraldalliance.com](http://www.emeraldalliance.com)

## ST MARKS COLLEGE, PORT PIRIE



The Benedict Resources Learning Centre, opened in September 2006, is part of the first stage of the 2005 master plan for the College. Located at the front of the primary campus, and incorporating associated ICT, special education and staff facilities, the design aims to reinforce and showcase an emphasis on resource based learning and information services. It comprises approximately 250m<sup>2</sup> of refurbished 1960s building and an articulated extension of around 115m<sup>2</sup>. The development has allowed the strengthening of clear pedestrian circulation routes within the campus with visibility through to internal activities from the pedestrian approaches into the school.

Whilst the extension has a strong contemporary form, care was taken not to detract from the identity of the Chapel which is located behind and relates to the internal courtyard. High level northern glazing is shaded by a deep eave whilst flooding the interior space with natural light.

Stage 1 also included refurbishment of the vacated library space for Art/T, central courtyard redevelopment, electrical upgrade at the senior Bosco Campus and asbestos roof replacement on both campuses.

Planned for construction in 2007, Stage 2 will replace the existing transportable Music and Home Economics buildings on the secondary Bosco Campus. The siting of the new Music and Home Economics Centres relates to the desire in the original master plan to provide external spaces of varying character and to commence the creation of a north-south axis for the campus. This arrangement will assist in unifying the campus design, allow connection to the courts to the south and allow for future expansion to the south. Facilities for Hospitality, Child Studies, Textiles, Cooking, Seminars, Meetings and Dining will be incorporated to support a growing curriculum focus in these specialist areas.

## WEST BELCONNEN, CANBERRA



Earlier this year we were invited by GMB Architects to jointly bid for a new "superschool" in the Canberra suburb of West Belconnen. Designed to replace the existing Gininderra High School and two local primary schools, the facility will cater for 1100 students from Pre-School to year 10.

Planning is well advanced, with Master Planning completed in August and the Preliminary Sketch Plans submitted in November. The school is due to be opened in 2009

## NETLEY OFFICES



Work is almost complete on the refurbishment of Building 2 at the Netley Office Park for a fitout for the Department for Families and Communities. A previous contract for the base building upgrade, including new lighting, air conditioning and internal finishes to the 1970 building was completed in July this year, and we are currently finalising the submission to the Green Building Council for Green Star rating of the project. If we are successful it would be the first green star rated refurbished office in South Australia

## COMPUTER LAB AND SKETCHUP

The following images are examples of how the use of software such as SketchUp can assist the development of complex design solutions. The new computer lab for the **University of Adelaide** involved the refurbishment of an existing storage space and transforming it into a computer lab for student use. The new facilities has direct links to the existing Barr Smith library and external access for after hours use. Using SketchUp helped to quickly explore a number of design options for the use of the existing space and was even used to explore detailed designs for new furniture layout and construction.



Russell & Yelland Architects  
101 Frederick Street  
Unley SA 5061

Ph 08 82714555  
[info@rusyel.com.au](mailto:info@rusyel.com.au)  
[www.rusyel.com.au](http://www.rusyel.com.au)